

DUAL PLATE CHECK VALVES

TECHNICAL DATA
MANUFACTURING STD.: API 594
TESTING & INSPECTION STD.: API 598

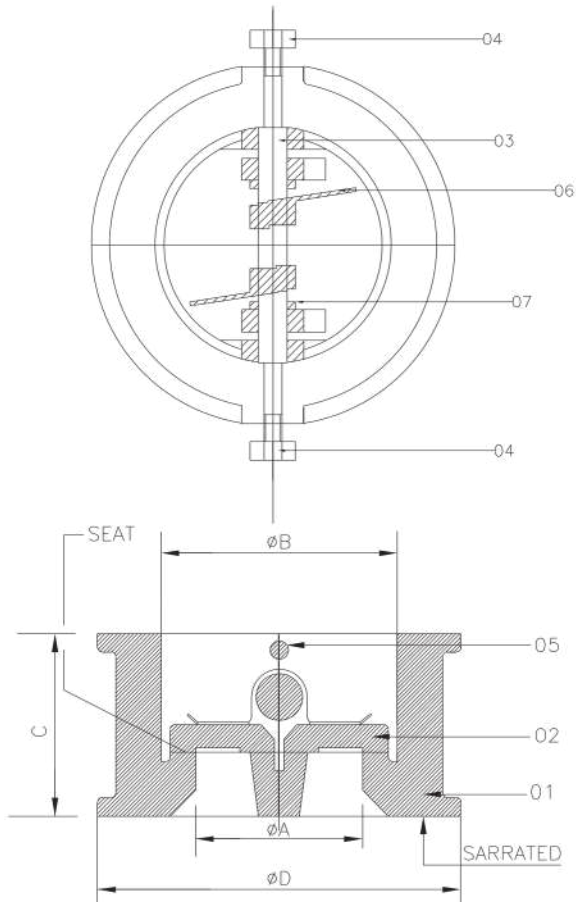

CLASS 125 / 150

NO.	DESCRIPTION	MATERIAL	QTY
01.	Body	CI/DI/SGI/WCG	1
02.	Disc	CI/DI/SGI/WCG	2
03.	HINGE PIN	S.S 316 (CF8)	1
04.	PLUG	S.S 316 (CF8)	2
05.	STOP PIN	S.S 316 (CF8)	1
06.	SPRING	S.S 316 (CF8)	2
07.	BEARING	S.S 316 (CF8)	1

SUITABLE FOR				
STEAM	WATER	OIL	AIR	GASES
	●	●		

CLASS-125				
SIZE	Ø A	Ø B	C	Ø D
50	50	60	54	105
65	65	75	54	154
80	76	90	58	136
100	100	115	63	174
125	125	135	70	196
150	150	165	76	222
200	200	220	95	279
250	250	265	108	340
300	300	320	142	409

CLASS - 150				
SIZE	Ø A	Ø B	C	Ø D
50	50	60	60	105
65	65	75	67	124
80	76	90	73	134
100	100	115	73	172
125	125	135	83	196
150	150	165	98	220
200	200	220	127	276
250	250	265	146	338
300	300	320	181	407
350	350	350	184	448
400	400	400	191	514
450	450	450	203	549
500	500	500	219	603
600	600	600	222	718

TEST PRESSURE BAR		
CLASS	SHEEL	SEAT
150	26	16